



FLINT™ GHSM

Flint™ GHSM series LED explosion proof lighting is designed to be installed in areas where flammable gases, vapors, or dusts are present in sufficient quantities to create a risk of explosion or fire.

CLASS I DIV. 1	CLASS I DIV. 2	 
CLASS II DIV. 1	CLASS III	

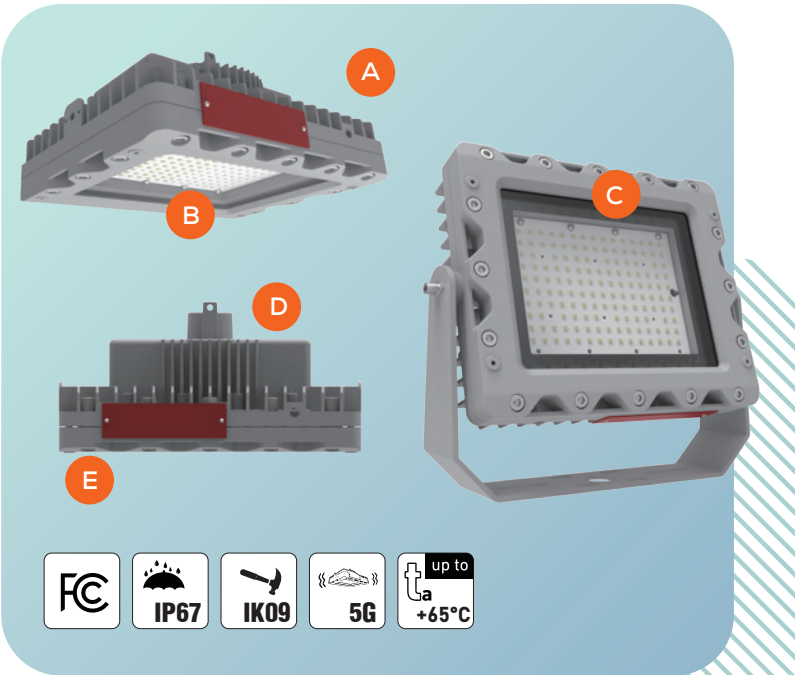

EXPLOSION PROOF AREA LIGHTING

CLASSIFICATIONS

NEC/CEC Standard

- UL 844 Hazardous Locations
 - Class I Division 1, Group B, C, D
 - Class I Division 2, Group A, B, C, D
 - Class II Division 1, Group E, F, G
 - Class II Division 2, Group F, G
 - Class III
 - Class I, Zone 1, Group IIB+H2
 - Class I, Zone 2, Group IIC

- CSA C22.2 No.137
- CSA C22.2 NO. 250.0:21
- UL 1598 Wet Locations
- UL 1598A Marine Outside Type (Salt Water)
- UL 8750 LED Safety
- ABS, FCC
- IP66/67 | IK09 | 5G | NEMA 4X

TECHNICAL DATA

ELECTRICAL & OPTICAL

Rated Power	20W/40W/60W
Input Voltage	100-277, 347-480V/AC
Lumen Output	3200lm ~ 9600lm
Luminous Efficacy	160 lm/W
Beam Angle	30°/60°/90°/110°/T2/T3/T4
Color Temperature	Amber 2700K 3000K 4000K 5000K
CRI	Ra>70

ENVIRONMENTAL & TECHNICAL

Ambient Temperature	-40°C~+65°C
Ambient Humidity	10%~90% RH
Lens Material	Tempered glass
Mounting Options	Pendant / Ceiling / Wall mount Stanchion / U-Bracket
Cable Entries	3/4" NPT, 1-1/4" NPT, 1-1/2" NPT

OPTIONS AND WARRANTY

- Transparent / frosted glass options
- Wire guard
- Safety cable
- Dark sky visor
- 20kV surge protector (10kV standard)
- 1-10V dimming capabilities
- L70 > 150,000 operation hours@ 25°C
- 5-year limited system warranty

KEY FEATURES

- A LIGHTWEIGHT AND COMPACT.** Low profile & lightweight with single chamber design. 129mm height is perfect for confined or low height areas.
- B HIGH EFFICIENCY.** Delivers up to 160 lm/W, utilizes special-treated glass for extreme application, providing high efficacy and long life.
- C MULTIPLE BEAM ANGLES.** 30°, 60°, 90°, 110°, T2, T3, T4, different lens provide more choices for various scenarios.
- D RETROFIT FRIENDLY.** Universal mounting accessories minimizes the SKUs and maximizes the flexibility.
- E BUILD TO LAST.** Copper-free aluminum housing and impact resistant lens sealed from the outside environment provides ingress protection against water and dust.

7 MOUNTING OPTIONS

